

MAKING AN ACCESS IN THE CEILING JOISTS TO INSTALL A CASSETTE

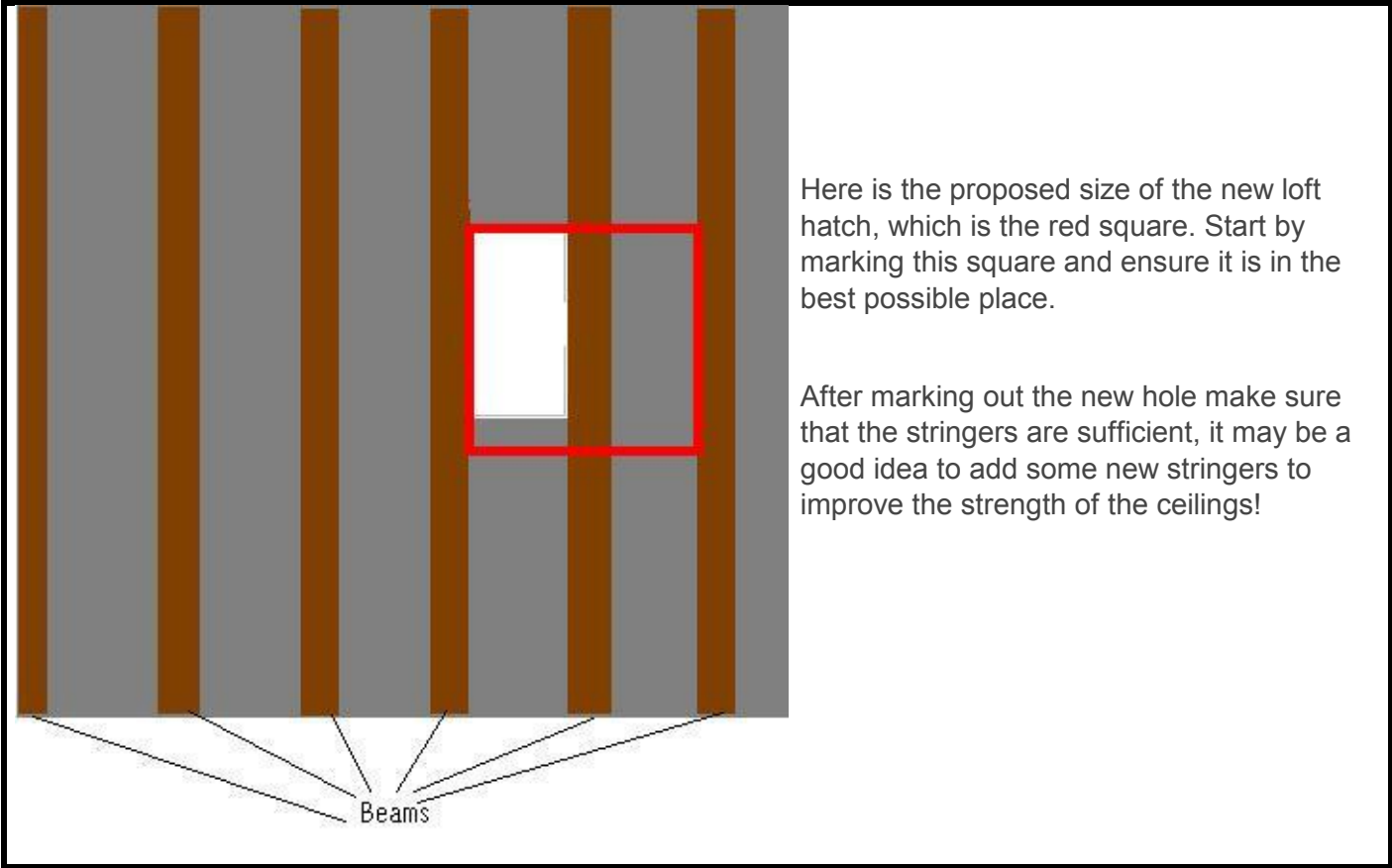

Here is the proposed size of the new loft hatch, which is the red square. Start by marking this square and ensure it is in the best possible place.

After marking out the new hole make sure that the stringers are sufficient, it may be a good idea to add some new stringers to improve the strength of the ceilings!

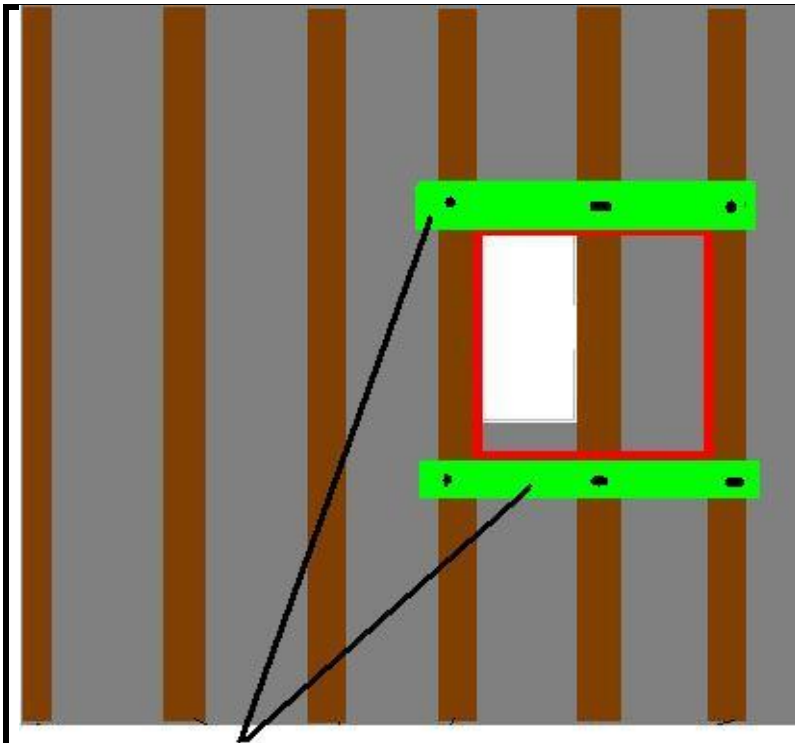

Start by screwing two pieces of strong timber (3 inch by 2 inch) across each end of the opening and screw it into all three beams.

Timber screwed into all three beams

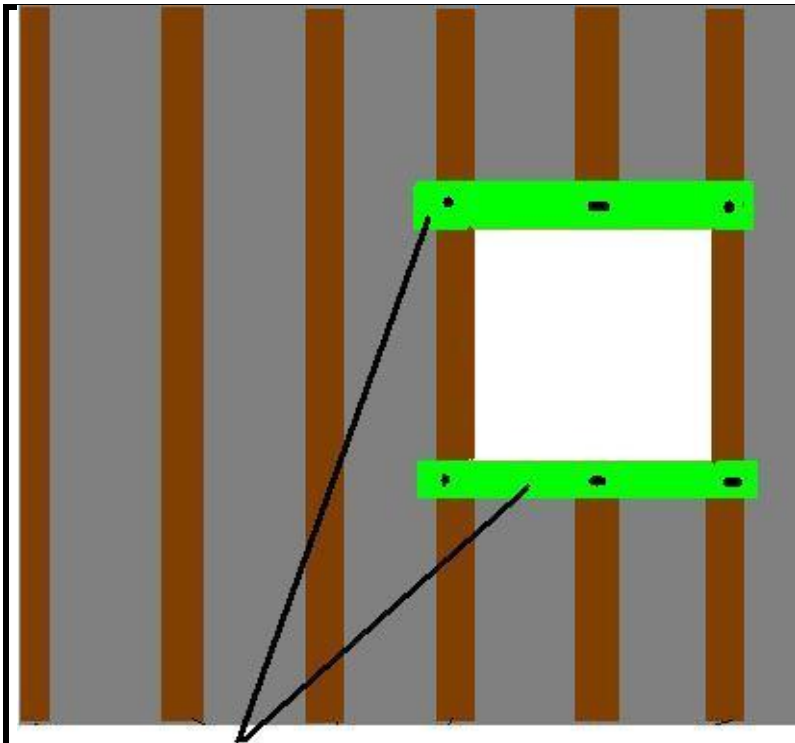

Timber screwed into
all three beams

After securing the two pieces of timber you can carefully cut away the plaster and the beam in the centre to reveal your enlarged opening.

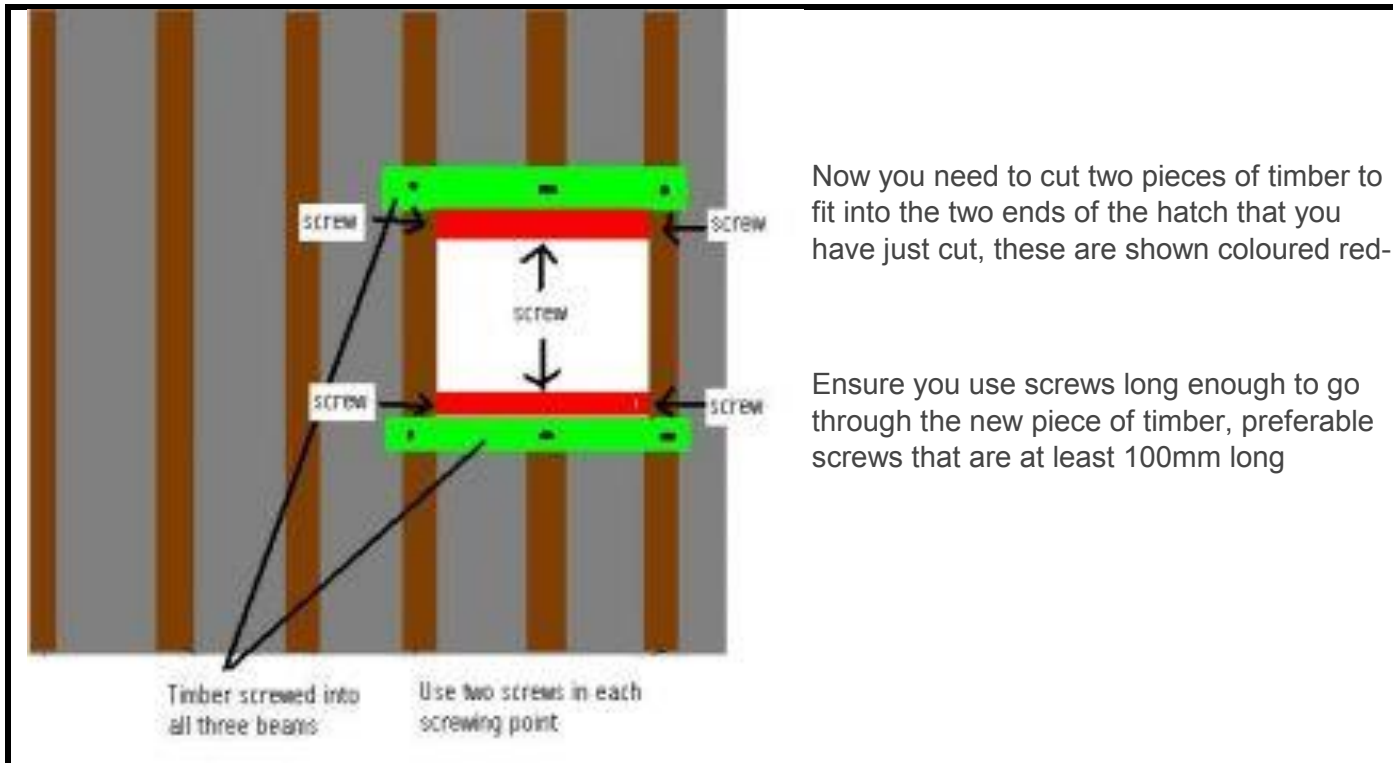

Now you need to cut two pieces of timber to fit into the two ends of the hatch that you have just cut, these are shown coloured red-

Ensure you use screws long enough to go through the new piece of timber, preferable screws that are at least 100mm long

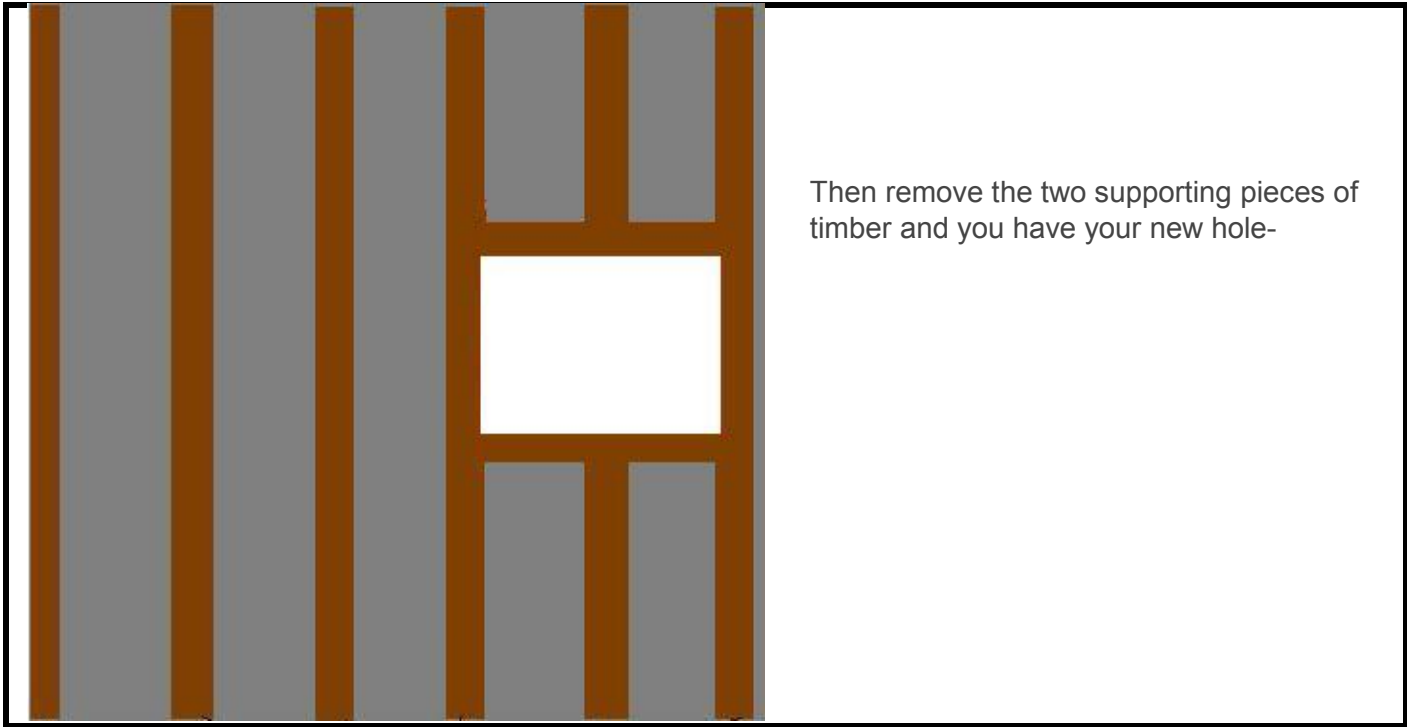

Then remove the two supporting pieces of timber and you have your new hole-